



BOWMAC[®]

06/2007

STRUCTURAL BRACKETS CATALOGUE

SUPERIOR QUALITY, HOT DIP GALVANISED, HEAVY DUTY BRACKETS FOR FIXING TIMBER TO TIMBER, TIMBER TO CONCRETE, TIMBER TO STEEL

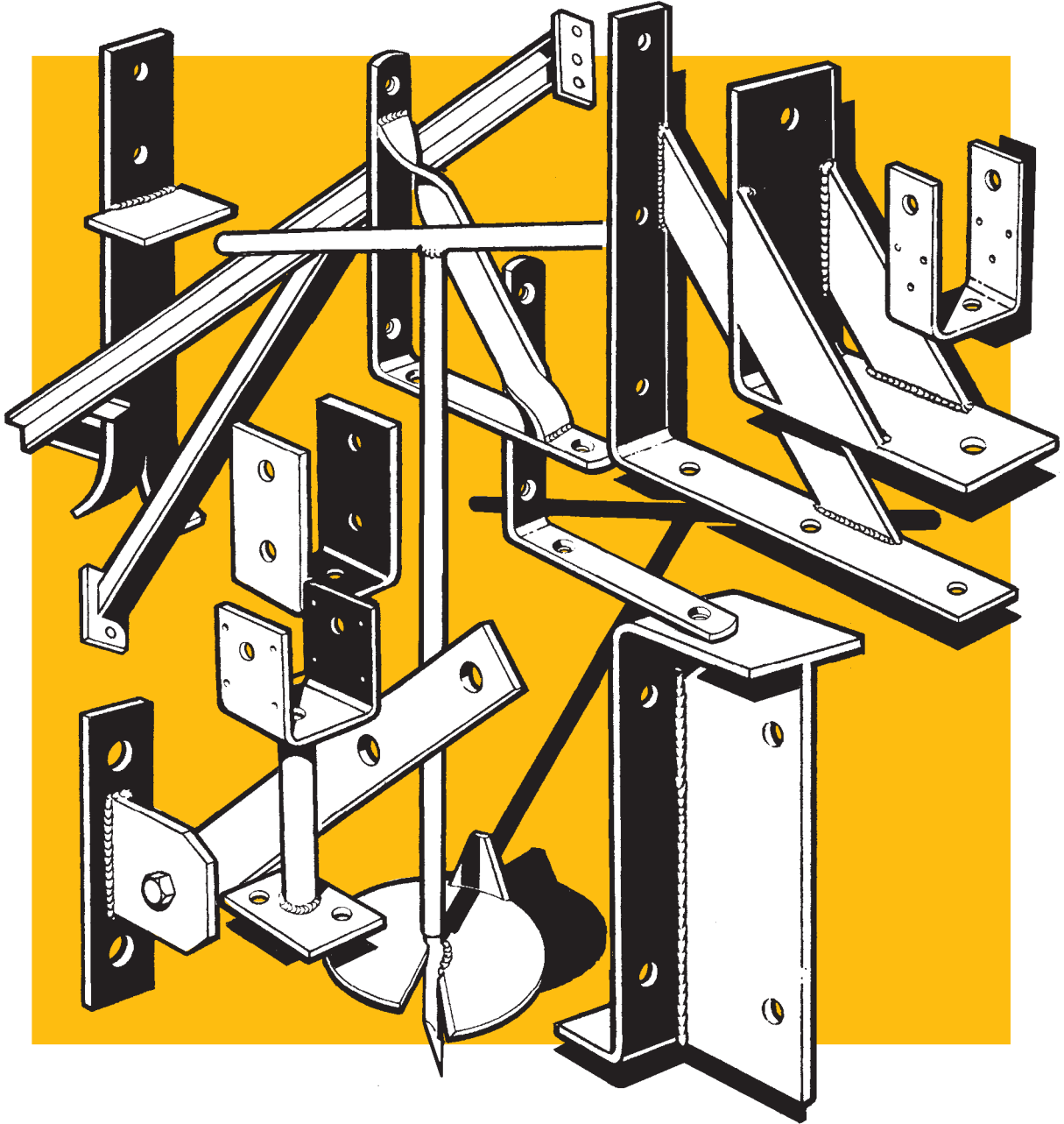

The BOWMAC product range is designed to cut building costs. The extensive range of brackets suits all types of timber construction, and provides the designer and builder with a versatile, economic and very extensive joining system.

BOWMAC Brackets are available from leading builders supply merchants throughout New Zealand.



DESCRIPTION

The BOWMAC product range of fixing brackets, supports and braces are specifically designed for use in all types of timber construction. All products utilise high grade steel and rigorous quality control ensures a quality product.

STANDARDS

Applicable timber standards are NZS 3603 and NZS 3604.

GALVANISING

All components are hot dip galvanised after manufacture to achieve an average of 900gm/m².

DESIGN LOADING

These can be derived from the allowable bolt loads in timber, using the relevant design code. Recommended loadings for pole to brace cleats B128, B145 & B155 only are shown here. Refer to separate brochure for loadings data.

STANDARD PRODUCT RANGE

This catalogue details the standard range of BOWMAC products. Refer to separate brochure for Stainless Steel 304 - 2B product.

SPECIAL PRODUCTS

BOWMAC also manufactures custom made products to suit specific requirements. A lead time by discussion is required to allow for manufacture.

AVAILABILITY

The BOWMAC product range is available from leading builders supply merchants throughout New Zealand.

END USE

The purchaser is responsible for checking the suitability of any component for its intended use.

POST AND BEARER BRACKETS

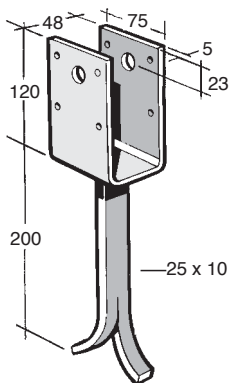

B132
(Nails Included Only)

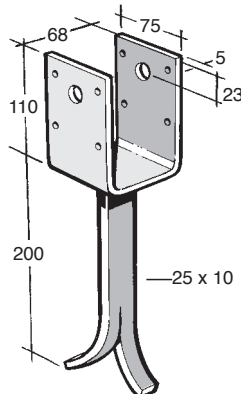

B133
(Nails Included Only)

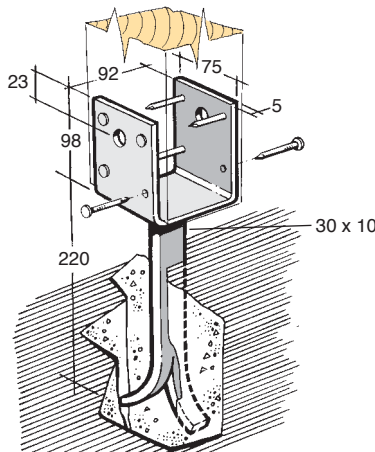

B134
(Nails Included Only)

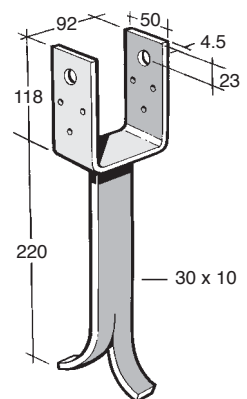

***B135**
(Nails & Bolt Included)

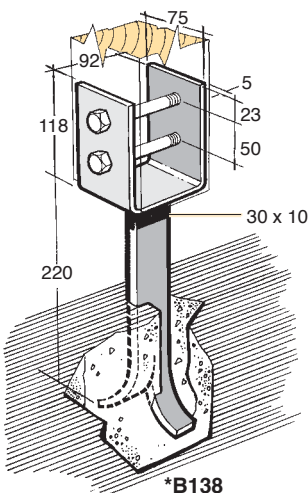

***B138**
(Bolts Included)

* Similar also available
in stainless steel 304-2B
Refer to brochure

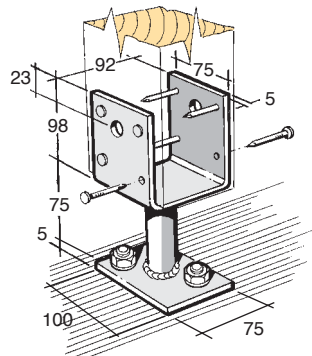

B12
(Nails Included Only)

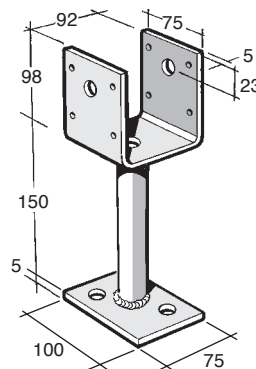

B14
(Nails Included Only)

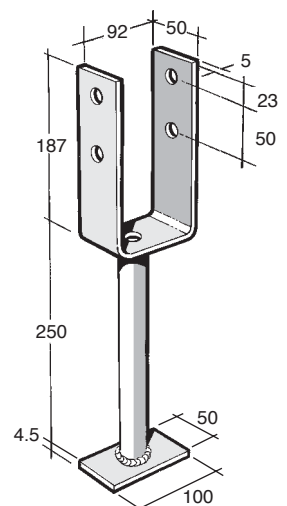

B16 (High Wind)
(Bolts Not Included)

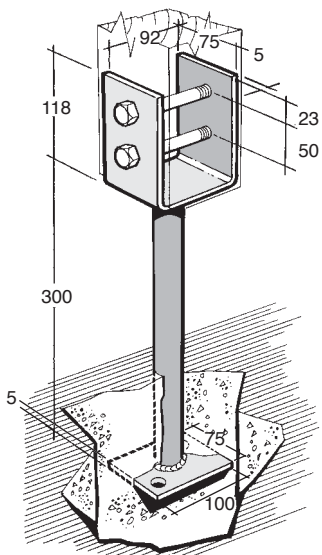

B18
(Bolts Included)

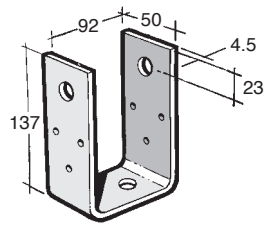

***B25**
(Nail, Bolt and 2 Dyna Bolts Included)

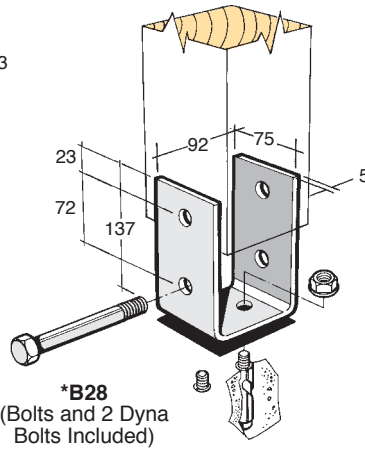

***B28**
(Bolts and 2 Dyna Bolts Included)

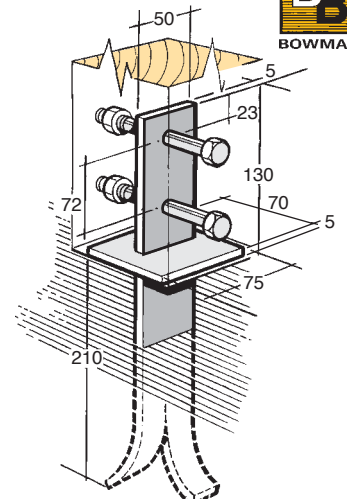

B195

BOLT & NAIL SIZES

FIXING NOTE

All bolt holes accommodate M12 Bolts unless noted.
Nail holes to accommodate 40mm x 3.15Ø F. Head square twisted shank nails.
Hot dip galvanised.

BOLTS NOT INCLUDED UNLESS NOTED

* Similar also available in stainless steel 304-2B
Refer to brochure

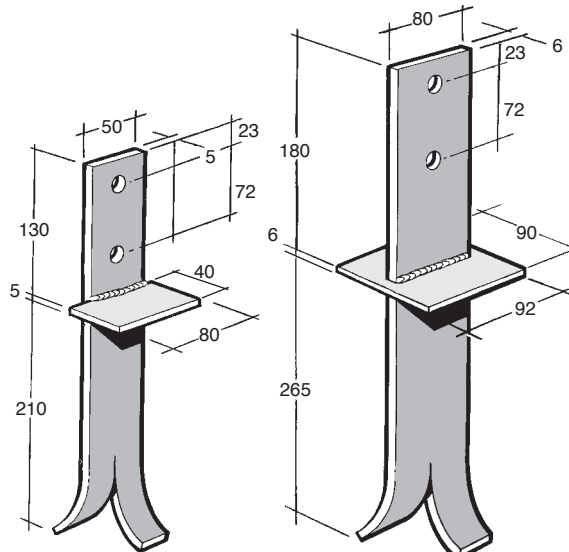

B196

***B197**

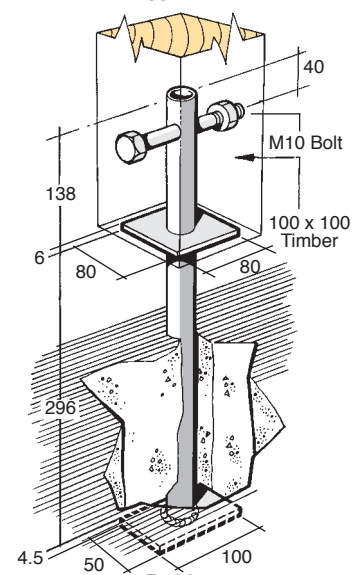

B198

STRAPS

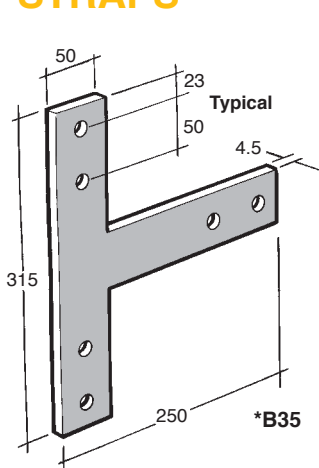

***B35**

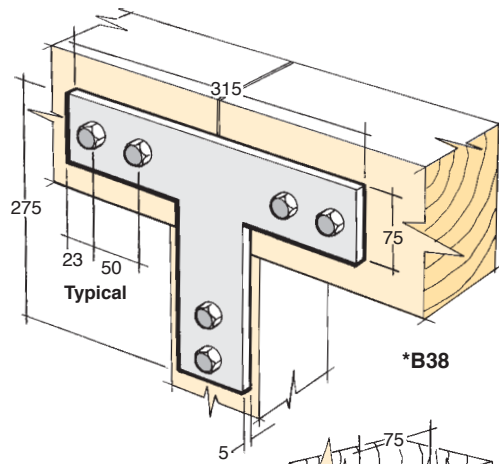

***B38**

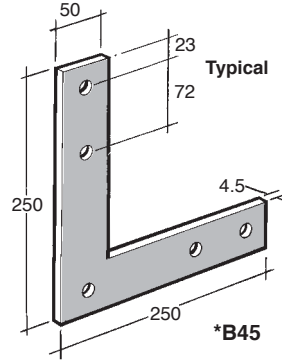

***B45**

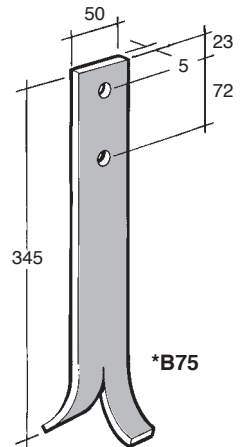

***B75**

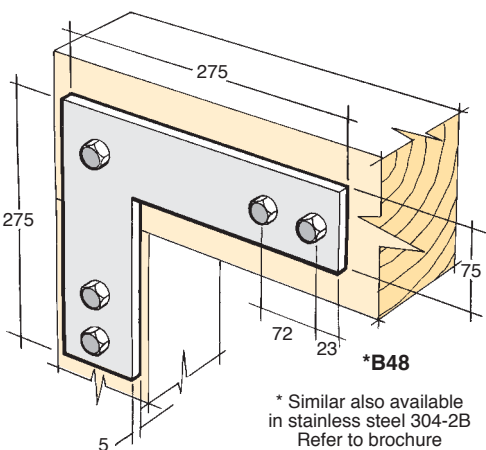

***B48**

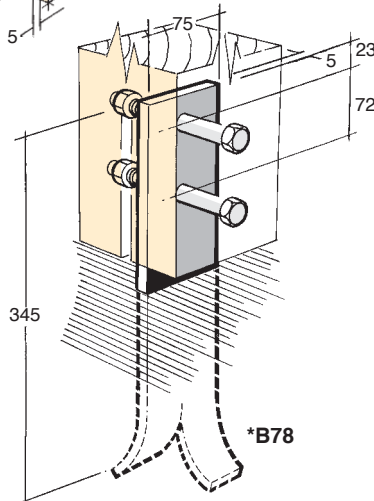

***B78**

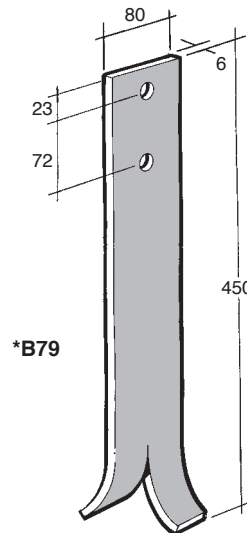

***B79**

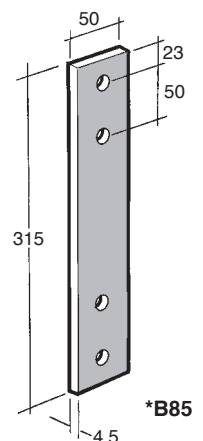

***B85**

* Similar also available in stainless steel 304-2B
Refer to brochure

BOLT & NAIL SIZES

All bolt holes to accommodate M12 Bolts unless noted.
 Nail holes to accommodate 40mm x 3.15Ø F. Head square twisted shank nails.
 Hot dip galvanised.

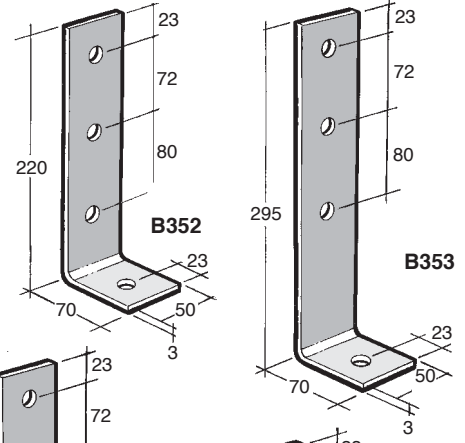
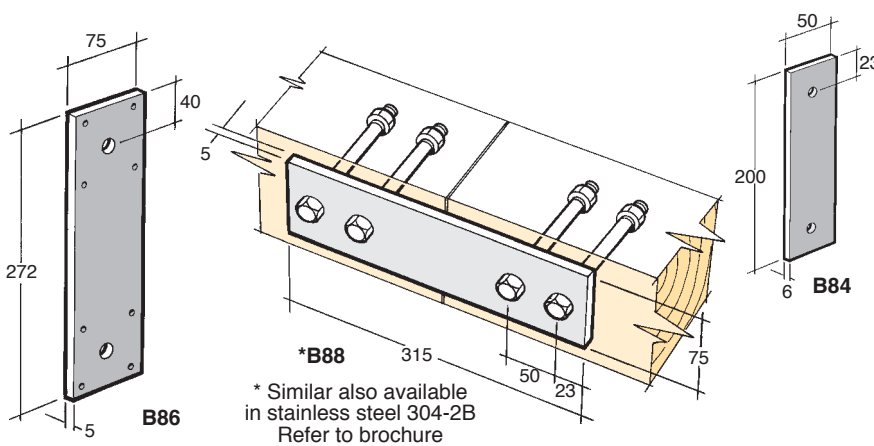

ANGLE BRACKETS (No Gusset)

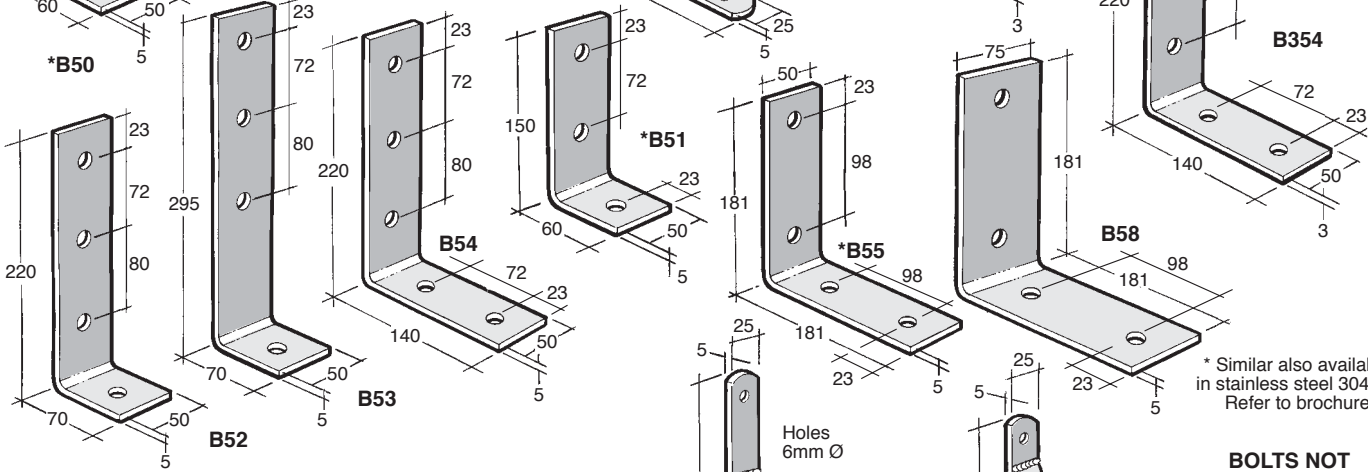
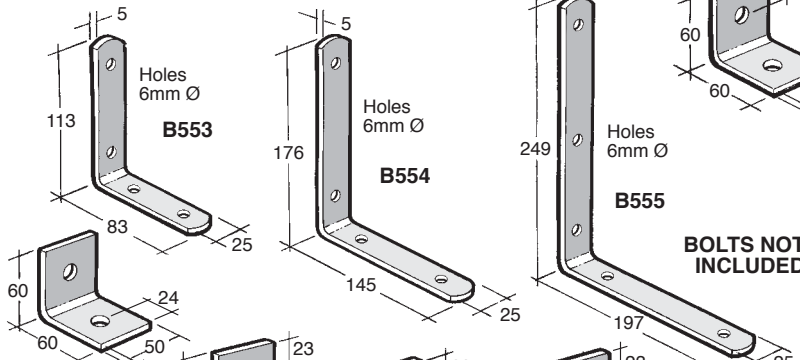

ANGLE BRACKETS (With Gusset)

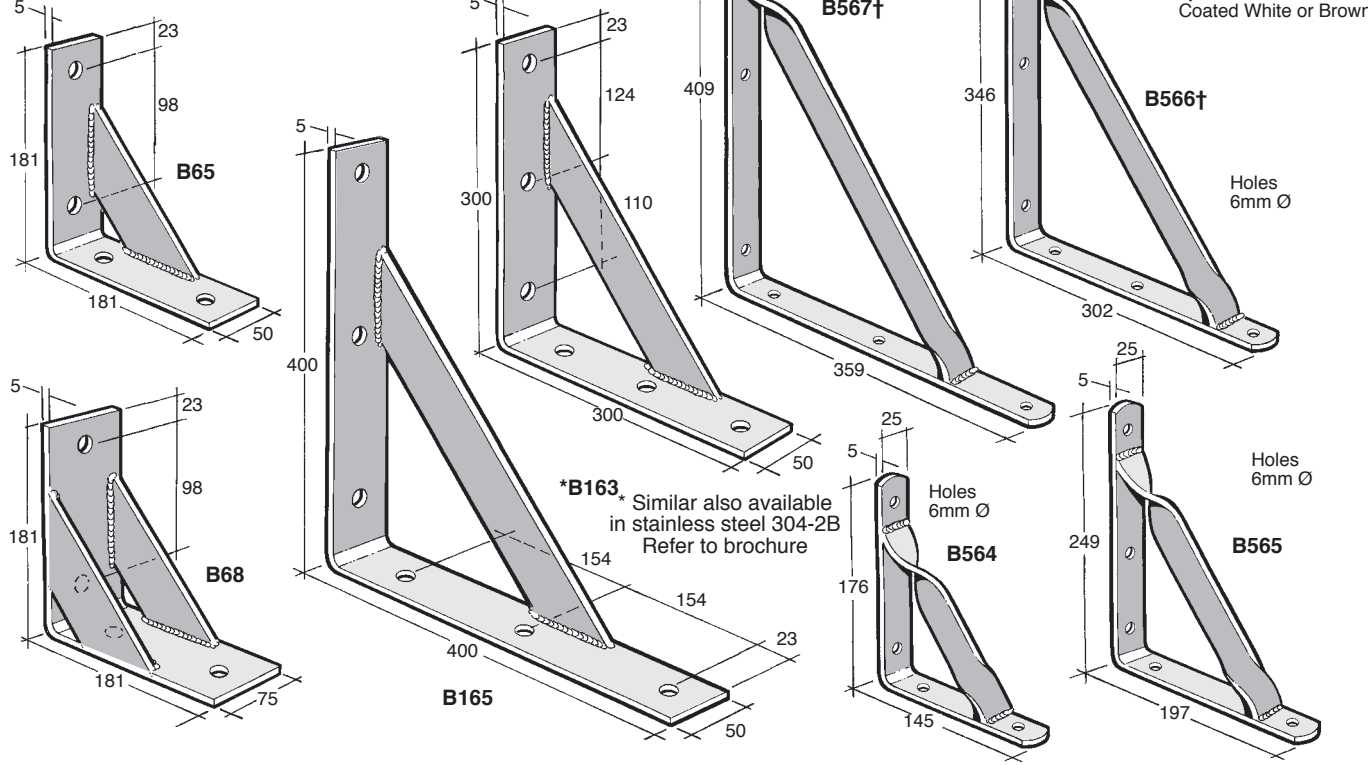

BOLTS NOT INCLUDED

* Similar also available in stainless steel 304-2B Refer to brochure

BOLTS NOT INCLUDED
 † Available in Powder Coated White or Brown

ANGLES

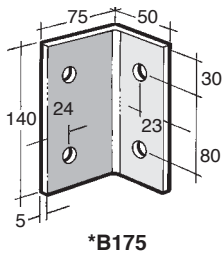

***B175**

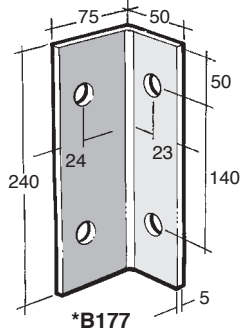

***B177**

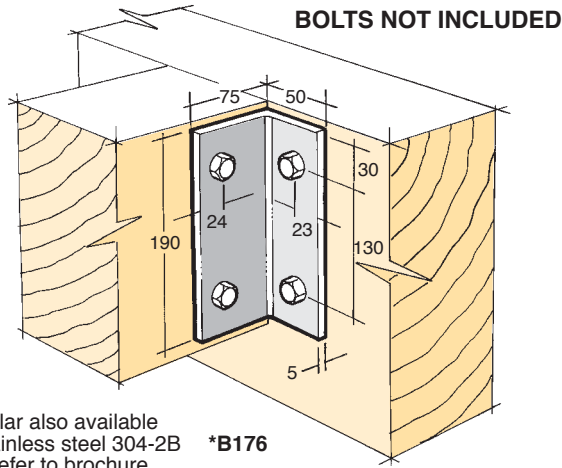

***B176**

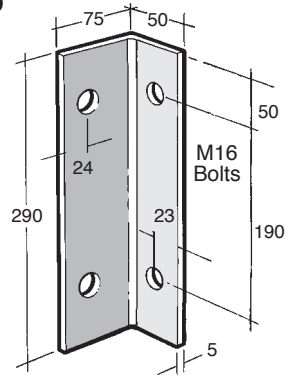

B178

BOLT SIZES

All bolt holes to accommodate M12 Bolts unless noted.

*Similar also available in stainless steel 304-2B Refer to brochure

Z & L BEAM SUPPORTS

*Similar also available in stainless steel 304-2B Refer to brochure

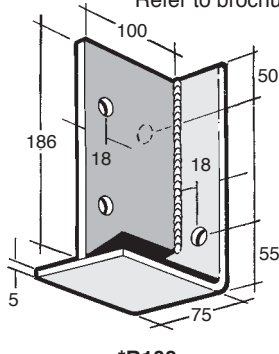

***B108**

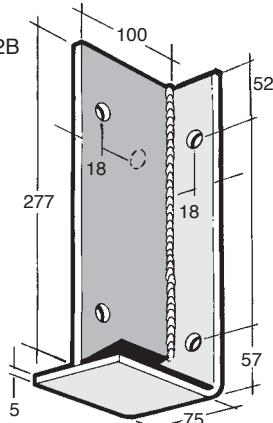

***B109**

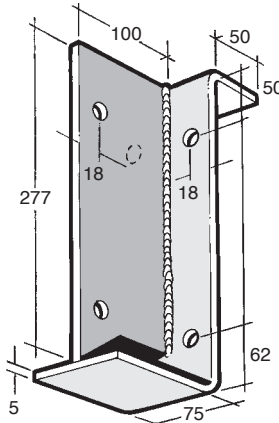

B99

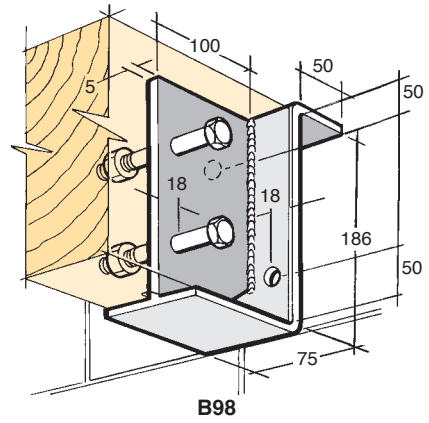

B98

BOLTS NOT INCLUDED

*B155 POLE BRACE BRACKET

Ex 50 x 5mm Plate 100 x 50 Channel Spacer. Supplied with 2-30mm x 16mm Ø Bolts and 2-140mm x 16mm Ø Bolts

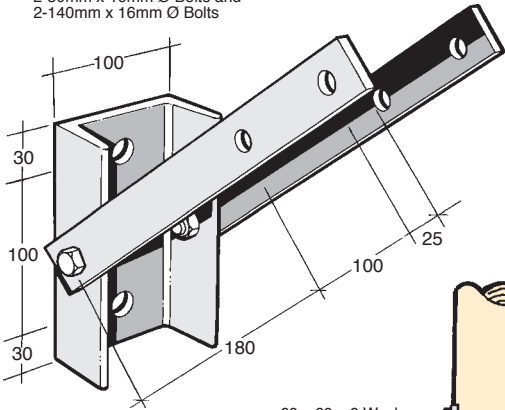

42kN CHARACTERISTIC LOAD TENSION AND COMPRESSION

60 x 60 x 6 Washers
20mm Ø Stud Bolts
Not supplied

*Similar also available in stainless steel 304-2B Refer to brochure

POLE BRACE BRACKET

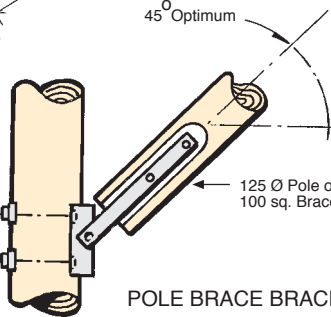

*B145 POLE BRACE BRACKET

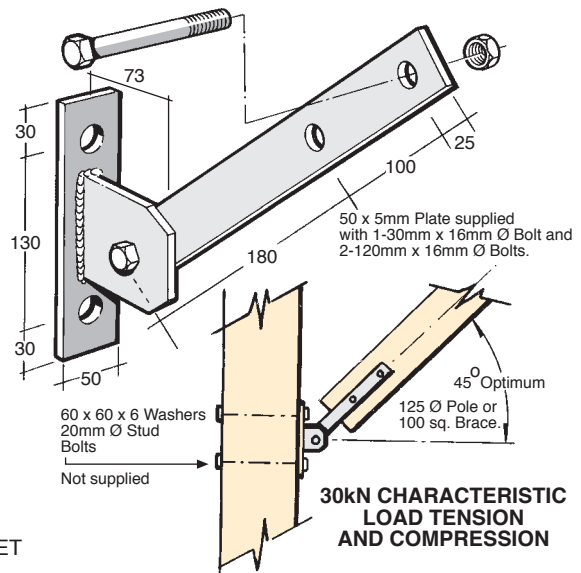

30kN CHARACTERISTIC LOAD TENSION AND COMPRESSION

B128 POLE BEAM BRACKET

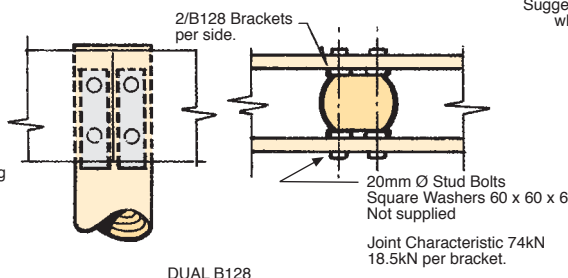
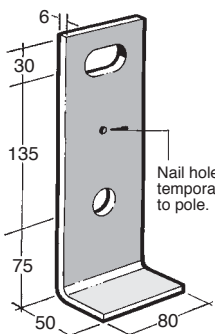

DUAL B128

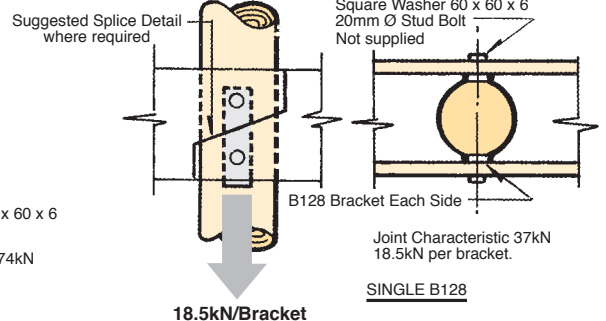

SINGLE B128

18.5kN/Bracket

POLE CONSTRUCTION DETAILS (BOLTS & WASHERS NOT INCLUDED)

B307 SCAFFOLD BRACKET

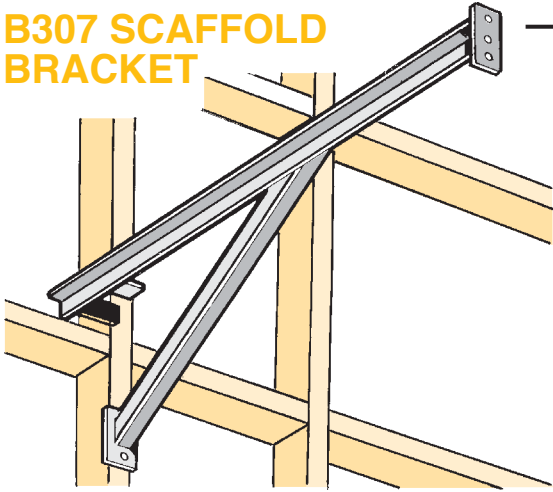

B303 CORNER BRACKET

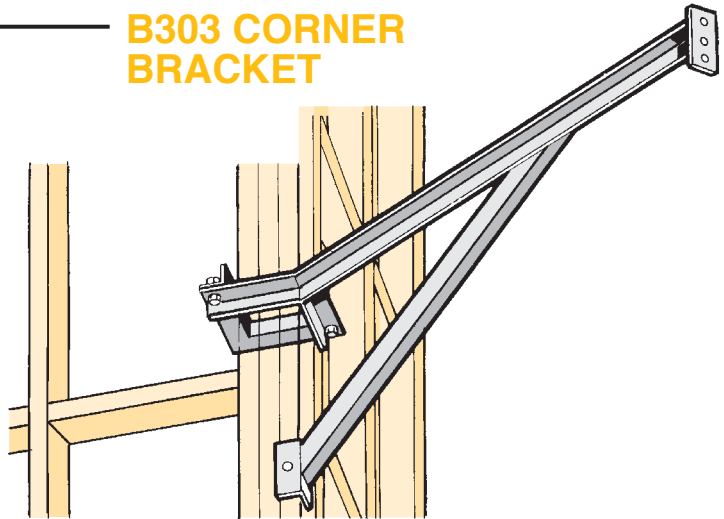

FENCE STAY BRACKET

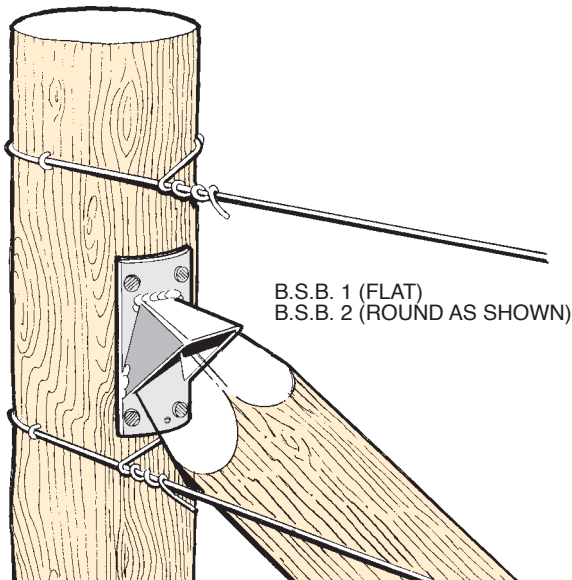

B.S.B. 1 (FLAT)
B.S.B. 2 (ROUND AS SHOWN)

BONZER BORER

| MODEL | SIZE |
|-------|------------|
| BB100 | 100mm Dia. |
| BB150 | 150mm Dia. |
| BB200 | 200mm Dia. |
| BB250 | 250mm Dia. |

